

**Thank you for purchasing K&H Manufacturing's Hangin' Feline Funhouse™. Proper care and adjustment should lead to many years of pleasure for your cat.**

### What is in the box?

(1) 600 denier Nylon with a vinyl backing Hangin' Feline Funhouse frame; (2) 4 Brackets; (3) Bumper/Spacers

### 1 Installation of door brackets:

**1.** Remove all contents from packaging taking care not to lose any parts.

**2.** Install top door brackets. Our unique door bracket system is made to fit virtually any standard household door. For most thicker exterior doors, i.e., front or back door of a home, the bracket can be used as is. For thinner interior doors such as a bedroom or closet door, we've provided stick-on silicone bumper/spacers to help remove excessive gap between the bracket and the door. When using the bumper/spacers, always determine first which side of the door your new Hangin' Feline Funhouse™ will hang on. The bumper/spacers should be attached to the inside of the bracket **OPPOSITE** of the door jamb (**See figure 1**). (Never put the bumper/spacers on the door jamb side of the bracket as this may prevent the door from properly closing.)

See figure 1.

**FIGURE 1**

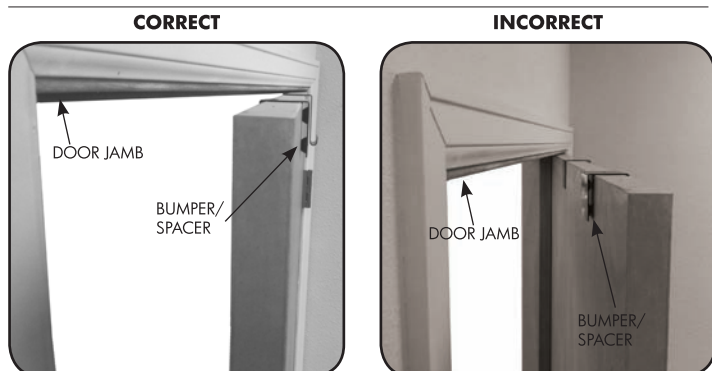

*Bumper/Spacers have been placed on the opposite side of the door from the door jamb, allowing the door to close properly*

*Bumper/Spacers have been placed on the side of the door that closes into the door jamb, not allowing the door to close properly*

### 2 Installing your Hangin' Feline Funhouse™:

**1.** Remove all contents from packaging taking care not to lose any parts.

**2.** Find the top of the Hangin' Feline Funhouse™ (The end with the long straps and flap which has a K&H logo on it is the **BOTTOM** of the Hangin' Feline Funhouse™)

**3.** Attach your Hangin' Feline Funhouse™ to the brackets hanging on top of your door. The clips on top of your Funhouse simply slide over the hook on the bottom of the door bracket. Note: The Funhouse has 2 top door brackets and 2 bottom door brackets. See **figure 2**.

**5.** Slide remaining 2 door brackets onto the bottom of your door. Adjust them accordingly so your Funhouse hangs straight.

**6.** Attach bottom adjustment straps to the brackets and pull the cinch strap lightly on the right and left side. See **figure 3**.

**FIGURE 2**

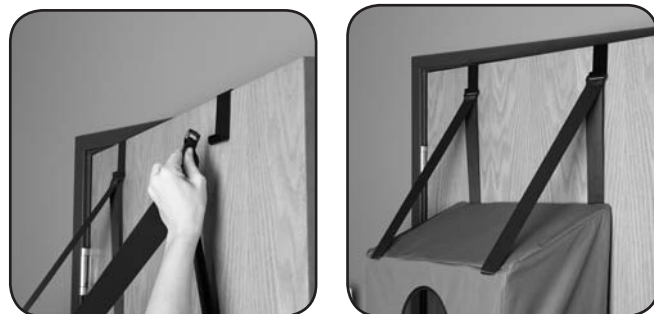

**7.** Step back and adjust the Hangin' Feline Funhouse™ on the top, and/or bottom. Be sure it is visually straight and where you want it.

**8.** Lastly, firmly pull down on each cinch strap to secure.

See **figure 3**.

**9.** Special Note: Floors are adjustable. If you would like to pull them out just pull straight up and rotate to move hole to other side of the Funhouse. See **figure 4**.

**FIGURE 3**

**FIGURE 4**



**With proper installation, your new Hangin' Feline Funhouse™ will be a secure, safe, space-saving addition to your home.**

**Care Instructions:** When the Hangin' Feline Funhouse™ is removed from packaging it is safe to steam in order to remove unwanted wrinkles. To clean, wipe with a damp cloth.

#### K&H Limited One Year Warranty

**Our warranty is as follows:** K&H Manufacturing warrants to the original consumer, that this product will be free of defects and workmanship for a period of one year from the date of purchase. The manufacturer's liability hereunder is limited to replacement of the product. This warranty is void if the product has been damaged by accident, unreasonable use, neglect, tampering, or other causes not arising from defects in material or workmanship.

**To exercise your warranty:** If, during the warranty period, your product malfunctions, return it to the place of purchase with your **original purchase receipt**. If this cannot be done, return the product, postage prepaid, to K&H Manufacturing, with **dated proof of purchase or original date receipt**. A return authorization number, obtained by calling (719) 591-6950 must accompany all returns to manufacturer. Please include a note explaining the problem when returning the product.