

Outdoor Heated Multi-Kitty A-Frame

(For Heated & Unheated Versions)

Care & Instructions

Made in China
K&H Pet Products, Central Garden & Pet
Colorado Springs, CO
www.khmf.com | (719) 591-6950



Thank you for purchasing K&H Manufacturing's Outdoor Heated Multi-Kitty A-Frame.™
These instructions apply to both the Heated and the Unheated versions.

When used correctly, your Outdoor Heated Multi-Kitty A-Frame™ should provide years of hassle free warmth for your pet. This product is intended for use indoors and outdoors and is perfect for garages, porches & barns.

The Outdoor Heated Multi-Kitty A-Frame™ by K&H is designed for use with animals only.

If you purchased the **unheated version** - disregard the instructions for the included K&H patented heated pad located on the back.

PUTTING TOGETHER YOUR Outdoor Heated Multi-Kitty A-Frame™

1 On a level surface, become familiar with your A-Frame house by unfolding it and laying it out flat. See **Figure 1**.

Figure 1

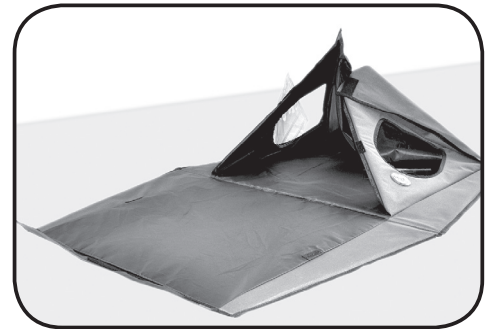

2 If you purchased the heated version, follow instructions on the back to set-up your K&H heated pad. If you purchased the unheated version disregard instructions on the back.

Next, unfold both the front and back wall panels that contain the doors and plastic door flaps. Identify which panel is the front of the house and which is the back. (*TIP: The front wall panel has a K&H logo patch on the outside of the A-Frame*).

Make sure the back panel is facing you. While holding both front and back wall panels up, insert the pad making sure the cord (*heated only*) is gathered towards the back end of the house. Position the pad facing up on the floor panel and hold in place. See **Figure 2**.

Floor panel

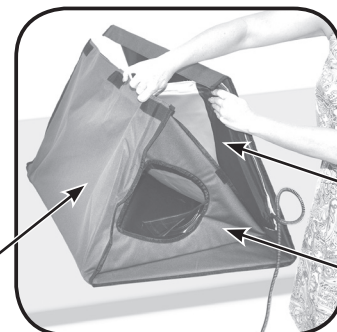

Figure 2

Insert pad

Back of A-Frame

3 Next, find the cord hole located in the crease of the back wall panel and floor panel (**3a**). Thread the cord through the cord hole (**3b**).

Cord hole is located in the crease of the back wall panel and floor panel

Figure 3

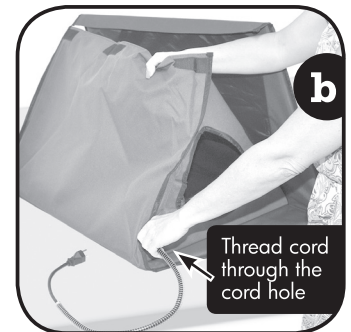

Thread cord through the cord hole

4 While continuing to hold the pad in place, close the house by bringing the adjacent side wall panel up to meet the front and back wall panels. Align the hook and loop material and press firmly to adhere as shown. Attach the hook and loop material on the side wall panels to the front and back wall panels as well. Adjust all as needed. See **Figure 4**.



Figure 4

5 Stand the A-Frame into the upright position. Your K&H Outdoor Heated Multi-Kitty A-Frame™ is now ready for use! See **Figure 5**.



Figure 5

Care Instructions:

Wash the bed's faux fleece cover on gentle cycle with cold water then line dry. To clean the A-Frame, wipe with a damp cloth.
Care instructions for the patented Heated Pad on reverse side.

K&H Heated Bed

Care & Instructions

Made in China
K&H Pet Products, Central Garden & Pet
Colorado Springs, CO
www.khmfg.com | (719) 591-6950



Thank you for purchasing K&H Manufacturing's patented heated pad. When used correctly, your heated bed should provide years of hassle free warmth for your pet. It is intended for use indoors and outdoors and is perfect for garages, porches, barns and dog or cat houses. Your heated bed is designed for use with animals only.

WARNING: This is an electrical product. Read all directions and precautions carefully before operating. Failure to properly follow all directions and instructions may lead to electrical shock or fire which could cause serious bodily injury.

USE INSTRUCTIONS

Read all instructions carefully. This is an electrical product, pay special care to IMPORTANT SAFEGUARDS.

- 1 Place directly on a hard, flat surface in the home or inside a doghouse or kennel. Area chosen should be a sheltered area out of direct rain or snow.
- 2 Plug into 110-120 volt AC outlet and allow 15 to 30 minutes for your heated bed to begin to warm and fully expand. The unit will feel slightly warm to the touch. The built in thermostat will automatically regulate the temperature.
- 3 After initial warm-up, your heated bed will feel cooler to the touch. This is the intention for energy efficiency. When your pet lies on the bed, it will warm to a cozy, pet pleasing temperature even in the coldest of weather.
- 4 Testing your heated bed. Place a blanket, pillow or other insulating object over part of your heated bed. After a few minutes, place your hand under the insulating object to experience the warmth your pet will enjoy.
- 5 To store your heated bed, unplug, clean, and store away when not in use.
- 6 **Save these instructions for your use.**

K&H Limited One Year Warranty

Our warranty is as follows: K&H Manufacturing warrants to the original consumer, that this product will be free of defects and workmanship for a period of one year from the date of purchase. The manufacturer's liability hereunder is limited to replacement of the product. This warranty is void if the product has been damaged by accident, unreasonable use, neglect, tampering, or other causes not arising from defects in material or workmanship.

To exercise your warranty: If, during the warranty period, your product malfunctions, return it to the place of purchase with your **original purchase receipt**. If this cannot be done, return the product, postage prepaid, to K&H Manufacturing, with **dated proof of purchase or original date receipt**. A return authorization number, obtained by calling (719) 591-6950 must accompany all returns to manufacturer. Please include a note explaining the problem when returning the product.

IMPORTANT SAFEGUARDS

For household Use Only*

**The heated pad is an electrical device and must only be operated inside an enclosure such as a porch, shed, barn, dog house, or cat house.*

When using electrical appliances, basic safety precautions should always be followed including the following:

READ ALL INSTRUCTIONS

- To protect against electrical hazards, **DO NOT** immerse cord, plug, or appliance in water or other liquid.
- **Close supervision is necessary** when used by or near children.
- **ALWAYS** unplug from outlet when not in use.
- **DO NOT** operate any electrical appliance with a damaged cord or plug, or if the appliance malfunctions or has been damaged in any way. **RETURN** all malfunctioning appliances to the factory for examination.
- **DO NOT** use appliance for anything other than its intended use.
- **DO NOT PUNCTURE PLASTIC HOUSING FOR ANY REASON.**
- For use with 110-120 volt AC **ONLY**.
- **DO NOT** cover your heated bed with blankets or materials other than a fleece K&H COVER. Other coverings may not allow heat to radiate properly and could cause pad failure.
- When used outside your home, this unit must be plugged into a properly grounded electrical outlet rated for outdoor use. If you do not have a properly grounded outlet, contact a certified electrician to have one installed.
- Always make sure the cord exits your pet's enclosure. Keep cord out of shelter.

Care Instructions:

Your K&H patented heated pad may be cleaned with a damp cloth when unplugged. The unit may be plugged in when the plug is thoroughly dry.